



- Easy installation with double-sided articulated body structure
- Potentiometric measurement
- Measuring distances from 50 mm to 750 mm
- 0.01 mm resolution
- Long life with 100 million moves
- High operating speed 5 m / s
- 5 K 10 K resistor options (other resistor values optional)
- Maximum angular Motion $\pm 30^\circ$
- High independent linearity 0,3 %

The LTP Series works with a potentiometric principle. Thanks to its high resolution of 0.01 mm, precise measurements can be made.

Since they are potentiometric, they operate as ABSOLUTE, they do not lose their position during power cuts and continue to measure from where they left off.

The linearized conductive plastic (Carbon + Plastic alloy) resistive alloy and special contacts are not affected by abrasion and operate for long periods with motion lives of up to 100 million. Because they make the resistance change linear by special methods, they make stable and equal measurements every time. They have angular motion capability during operation and mounting up to max. 30° due to articulation.

LTP Series Potentiometric Linear Transducer Usage Areas:

- Bending Presses
- Marble Machines
- Blood Pressure Control Systems
- Saw Machines
- Transfer Machines
- Hydraulic Machines
- Metal Working Benches
- Pipe Bending Machines
- Textile Machinery
- Other automation applications

Technical Specifications

| | |
|-------------------------------------|---|
| Length Options / Measuring Distance | 50 - 75 - 100 - 125 - 150 - 175 - 200 - 225 - 250 - 275 - 300 - 325 - 350 - 360 - 375 - 400 - 450 - 500 - 550 - 600 - 650 - 700 - 750 |
| Resistance Element | Conductive Plastic |
| Output Signals | Potentiometric (Voltage Divider) |
| Independent Linearity | $\pm 0,3\%$ |
| Socket Connection | 4 pin female socket |
| Power Supply | Max. 42 VDC |
| Resistance | 5K or 10Kohm and other ($\pm 20\%$ tolerance) |
| Operating Temperature | -30°C $+100^\circ\text{C}$ |
| Life | 100 million movements |
| Mechanical Connection | With double sided articulated or handcuffs |
| Spindle Material | Stainless steel |
| Body Material | Anodized aluminium |

Order Code

Model No

L

T

P

-

3

0

0

Length Options / Measuring Length

Choice of measuring sizes from 50 mm to 750 mm

Output Signal

Products with potentiometric output do not contain codes.

Package Included

1 Connector / 4 pin female socket (DIN43650)

Recommended Accessories

Process-controlled indicators "ALP Series"



Mechanical Measurements

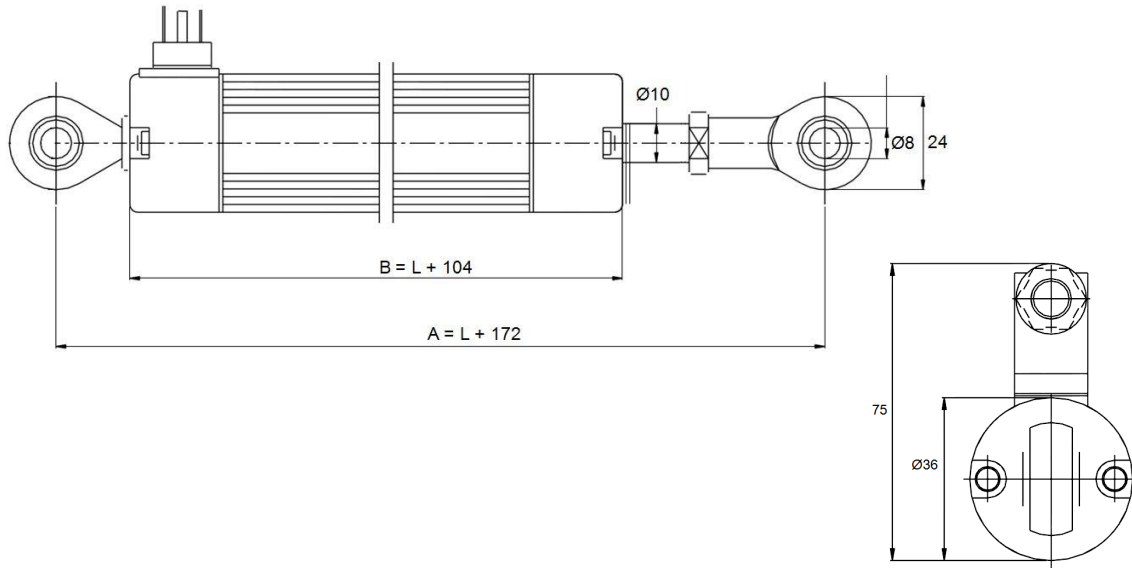

Connections

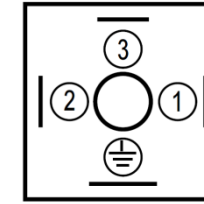

POTENTIOMETRIC OUTPUT

1. Resistance / + Supply
2. COMMON
3. Resistance / - Supply
4. SHIELD

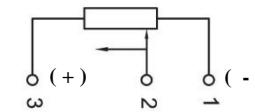

Potentiometric connection
(Voltage Divider)

| TYPE Series | LTP 50 | LTP 75 | LTP 100 | LTP 125 | LTP 150 | LTP 175 | LTP 200 | LTP 225 | LTP 250 | LTP 275 | LTP 300 | LTP 325 | LTP 350 | LTP 360 | LTP 375 | LTP 400 | LTP 450 | LTP 500 | LTP 550 | LTP 600 | LTP 650 | LTP 700 | LTP 750 |
|---|--------|--------|---------|---------|---------|---------|---------|---------|---------|---------|---------|---------|---------|---------|---------|---------|---------|---------|---------|---------|---------|---------|---------|
| STROKE (L) | 50 | 75 | 100 | 125 | 150 | 175 | 200 | 225 | 250 | 275 | 300 | 325 | 350 | 360 | 375 | 400 | 450 | 500 | 550 | 600 | 650 | 700 | 750 |
| RESISTANCE (Kohm) | 5K | 5K | 5K | 5K | 5K | 5K | 5K | 5K | 5K | 5K | 5K | 5K | 5K | 5K | 5K | 5K | 5K | 5K | 5K | 5K | 10K | 10K | 10K |
| MECHANICAL STROKE (mm) | 54 | 79 | 104 | 129 | 154 | 179 | 204 | 229 | 254 | 279 | 304 | 329 | 354 | 364 | 379 | 404 | 454 | 504 | 554 | 604 | 654 | 704 | 754 |
| ELECTRICAL STROKE (mm) | 50 | 75 | 100 | 125 | 150 | 175 | 200 | 225 | 250 | 275 | 300 | 325 | 350 | 360 | 375 | 400 | 450 | 500 | 550 | 600 | 650 | 700 | 750 |
| MECHANICAL DIMENSIONS | | | | | | | | | | | | | | | | | | | | | | | |
| DISTANCE BETWEEN ARTICULATED (A) (mm) ±2 mm | 222 | 247 | 272 | 297 | 322 | 347 | 372 | 397 | 422 | 447 | 472 | 497 | 522 | 532 | 547 | 572 | 622 | 672 | 722 | 772 | 822 | 872 | 922 |
| BODY LENGTH (B) (mm) ±2 mm | 154 | 179 | 204 | 229 | 254 | 279 | 304 | 329 | 354 | 379 | 404 | 429 | 454 | 464 | 479 | 504 | 554 | 604 | 654 | 704 | 754 | 804 | 854 |